



4 K BIG PAD Application Guide 【Wireless Casting】

**Product :
PN-65HC1
PN-75HC1
PN-86HC1
PN-70HC1E**

<p>Ver. 1.5 for Firmware Ver. 1.60 (PN-86/75/65HC1) Ver. 1.35 (PN-70HC1) or later</p>

Introduction

【About EShare】

The screen can be shared and displayed mutually between the BIG PAD and the device.
The BIG PAD and the device to be connected must be connected to the same network.

*Connection to all devices is not guaranteed. *A router or access point is required.

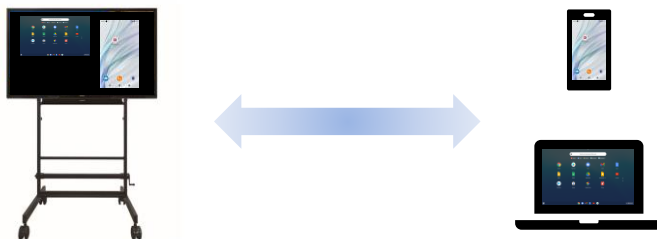

【Supported devices】

device type	OS	supported version
PC	Windows	Windows 8.1/10/11
	Chrome OS	EShare: Chrome OS version 87 or later Google Cast: Chrome OS version 92 or later
	macOS	macOS 10.15/11
Smart device (Smartphone, tablet PC)	Android	Android 8/9/10/11
	iOS/iPadOS	iOS 13/14/15 iPadOS 13/14/15

*Since the main firmware ver. 1.60, the EShare application for Android, which can be obtained by following the instructions in this manual, has been changed.

【Main Features】

Feature	About	supported devices
Share Screen	Share the client device screen to the BIG PAD. Voice transmission is not supported when using the EShare app on Android 9 or earlier devices or Chrome OS devices. Touchback is only available on Windows and macOS devices.	All devices
Mirroring	Mirror the BIG PAD to the client device. (External input and media player screens cannot be shared.)	All devices (Excluding Google Cast devices)
File sharing	Share audio, video and photo file from smart devices to BIG PAD.	Smart devices
Wireless camera and microphone	Share the images or audio from phone camera or microphone to the BIG PAD in real time.	Smart devices
Multiple screens	Share multiple device screens to BIG PAD at the same time, and the screen of BIG PAD will be split automatically. (Max. 4 screens) (You can connect up to 1 Google Cast device out of 4 screens)	All devices
Display group	Users can share their screen from 1 client device to multiple BIG PAD wirelessly.	All devices (Excluding Google Cast devices)

Preparation (BIG PAD)

【BIG PAD】

First, connect to a wireless network.

Press the INPUT button on the remote control or the bottom of the BIG PAD to change the input mode to APPLICATION and display the home screen.

1. Connect the supplied wireless adapter to the USB port on the rear panel as shown below.

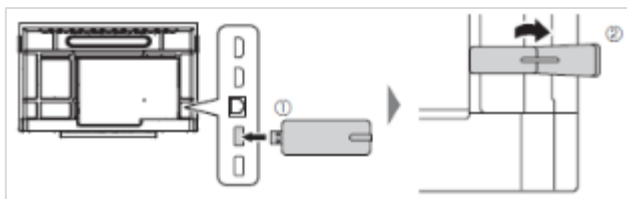

2. On the BIG PAD, select "Apps" on home screen in APPLICATION mode.

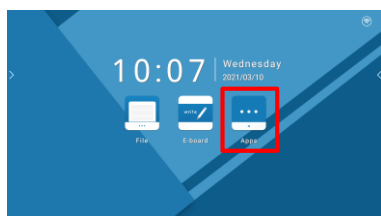

3. Select "Settings".

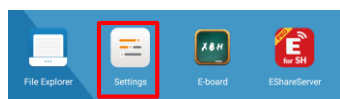

4. Select "Network".

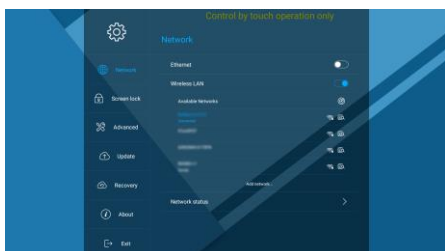

5. Enable "Wireless LAN" and connect to the access point.

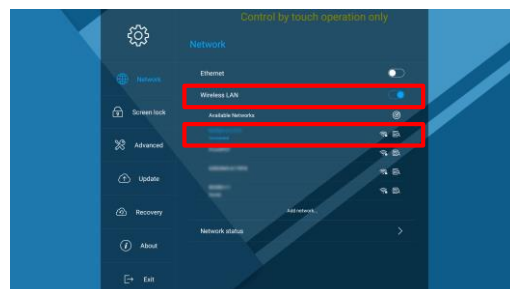

Make preparations for network connection and application installation on each device.

■ How to set up each device

(1)Windows	... p.3
(2)Chrome OS	... p.3
(3)macOS	... p.4
(4)Android	... p.5
(5)iOS/iPadOS	... p.5

For detail on how to share the screen on each device, please refer to the following page.

■ How to use each device

(1)Windows	... p.6
(2)Chrome OS	... p.7
(3)macOS	... p.8
(4)Android	... p.9
(5)iOS/iPadOS	... p.10

Preparation (Windows/Chrome OS)

【Windows PC】

- Configure the wireless LAN connection settings of the PC (The following screens are on windows 10 1903)

Turn on the wireless LAN

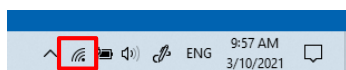

Connect to an access point on the same network as the BIG PAD

- Install “EShare for SH”. (First time only)

1. On the BIG PAD, select “Apps” on home screen in APPLICATION mode.

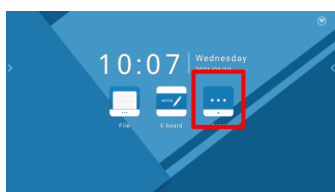

2. Select “EShareServer”.

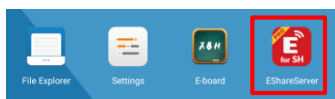

3. Access the address displayed on the screen of the BIG PAD from your PC.

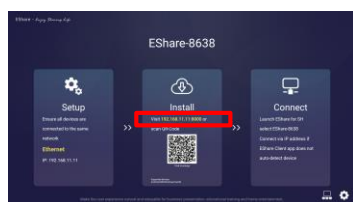

4. Select “EShare for Windows” on the PC.

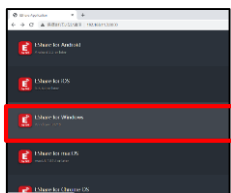

5. Follow the instructions in the installer to install EShare.

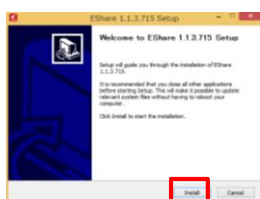

【Chrome OS PC】

*To wirelessly connect the Chrome PC to the BIG PAD, you will need to connect to the internet for the first time.

- Configure the wireless LAN connection settings of the PC (The following screens are on Chrome OS version 88)

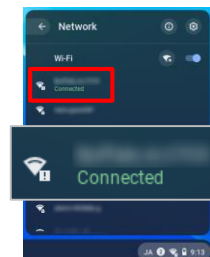
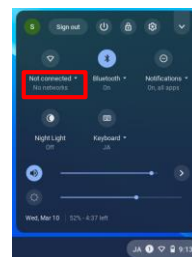

Connect to an access point on the same network as the BIG PAD

- 【When using “EShare”】
Install “EShare”. (First time only)

1. On the BIG PAD, select “Apps” on home screen in APPLICATION mode

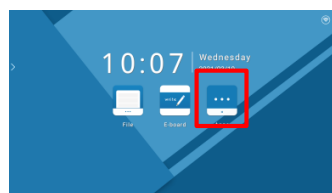

2. Select “EShareServer”

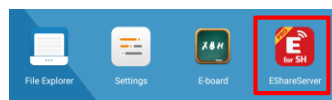

3. Access the address displayed on the screen of the BIG PAD from your PC.

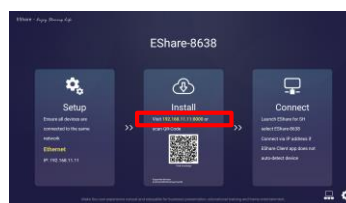

4. Select “EShare for Chrome OS” on the PC.
(connect to an external site)

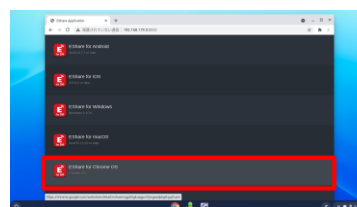

5. Select “Add to Chrome” to download.



Preparation (macOS)

【macOS PC】

- Configure the wireless LAN connection settings of the PC (The following screens are on macOS v10.15)

Turn on the wireless LAN

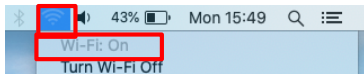

Connect to an access point on the same network as the BIG PAD

- Install “EShare for SH”. (First time only)

1. On the BIG PAD, select “Apps” on home screen in APPLICATION mode.

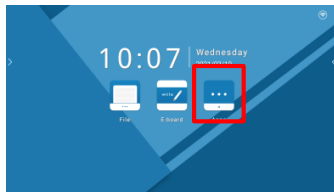

2. Select “EShareServer”.

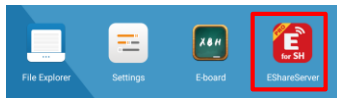

3. Access the address displayed on the screen of the BIG PAD from your PC.

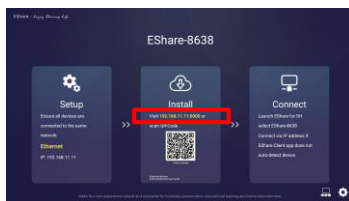

4. Select “EShare for macOS” on the PC.

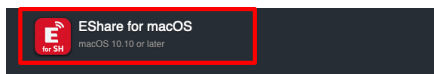

5. Follow the instructions in the installer to install EShare.

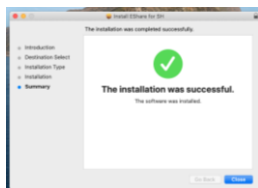
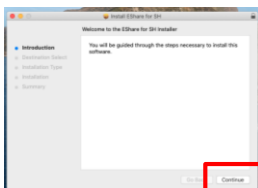

- Touch back

To enable the function of receiving touches to the BIG PAD as touches to the device while the device is transmitting the screen, you need to change the setting.

1. Click “System Preferences”.



2. Select “Security & Privacy”.

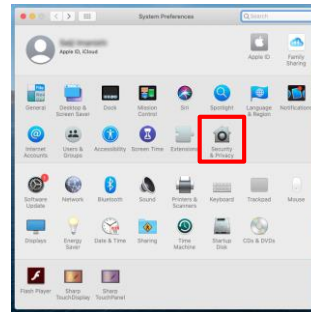

3. Select “Privacy”, Select “Accessibility”, Click on the lock icon in the lower left corner.

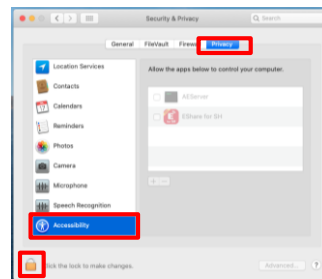

4. Input the user name and the password.

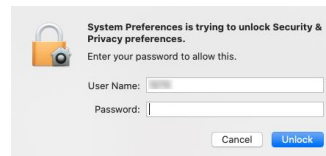

5. Click “EShare for SH” check box.



Preparation (Android/iOS,iPadOS)

【Android device】

- Configure the wireless LAN connection settings of the device

(The following screens are on Android 9)

Press and hold  to open Wi-Fi setting screen

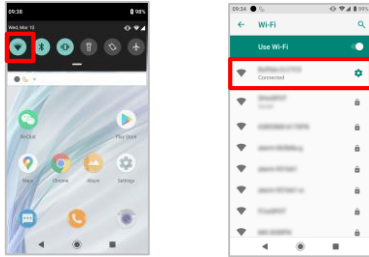

Connect to an access point on the same network as the BIG PAD

- Install “EShare for SH”. (First time only)

1. On the BIG PAD, select “Apps” on home screen in APPLICATION mode.

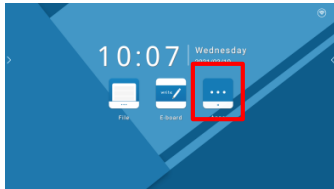

2. Select “EShareServer”.

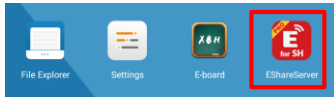

3. Access the address displayed on the screen of the BIG PAD from your device.

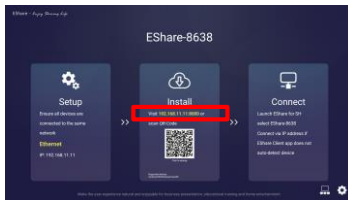

4. Select “EShare for Android” on the android device.

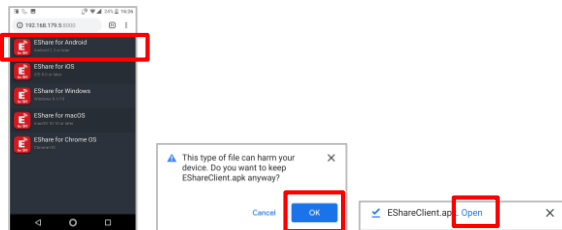

5. Download and install the app.

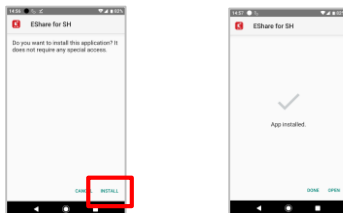

【iOS/iPadOS device】

*To wirelessly connect the iOS/iPadOS device to the BIG PAD, you will need to connect to the internet for the first time.

- Configure the wireless LAN connection settings of the device

(The following screens are on iOS/iPadOS 14)

Press and hold  to open Wi-Fi setting screen

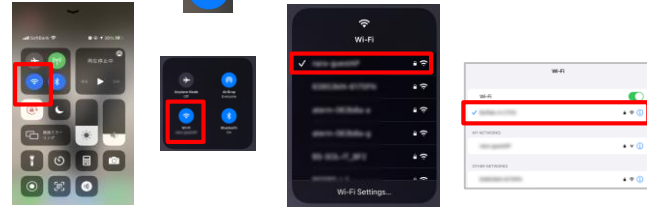

Connect to an access point on the same network as the BIG PAD

- Install “EShare for SH”. (First time only)

1. On the BIG PAD, select “Apps” on home screen in APPLICATION mode.

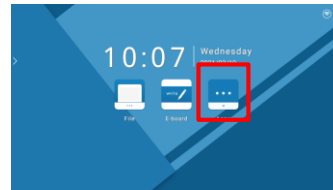

2. Select “EShareServer”.

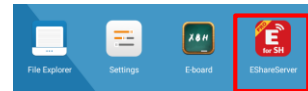

3. Access the address displayed on the screen of the BIG PAD from your device.



4. Select “EShare for iOS” on the iOS/iPadOS device (connect to an external site).

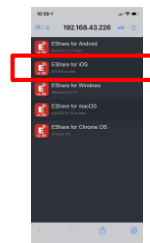

5. Download and install the app.



Wireless Connection (Windows)

[Windows PC]

- Operate “EShare for SH” on the Windows PC

1. Click “Eshare for SH” 

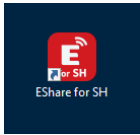

2. Select the BIG PAD you want to send and receive screen from the device list.

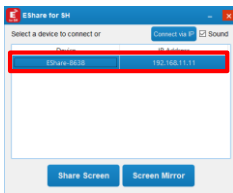

3. To display the screen of your PC on the BIG PAD, select “Share Screen”.
Select “Stop Sharing” to stop screen sharing.

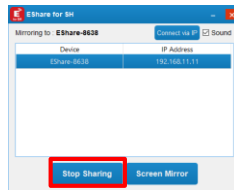
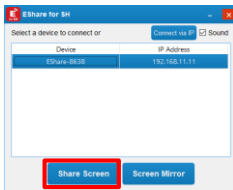

4. To display the BIG PAD screen on your PC, select “Screen Mirror”.

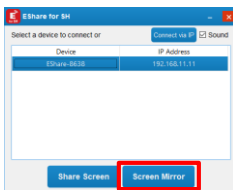

The BIG PAD screen will appear on your PC.

Click the “x” in the upper right corner of the windows to stop screen mirroring.

Wireless Connection (Chrome OS)

【Chrome OS PC】

【When using "EShare"】

- Operate "EShare for SH" on the Chrome OS PC

1. Open the launcher and Click "EShare for SH".

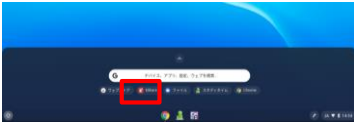

2. Select "Connect"

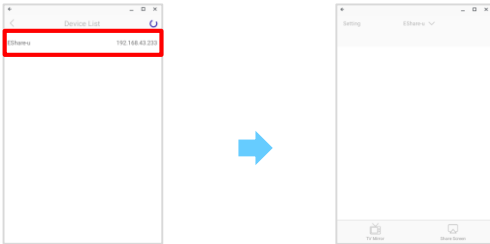

3. To display the screen of your PC on the BIG PAD, select "Share Screen".
Click the screen you want to display, and select "share".

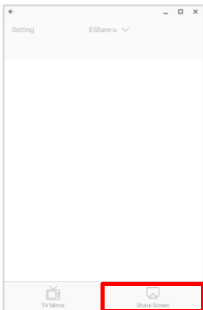

4. To display the BIG PAD screen on your PC, select "TV Mirror".

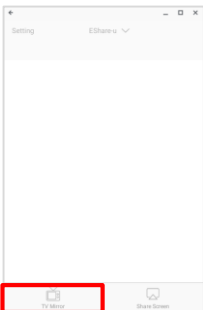

【When using Google Cast】

- Operate the Chrome OS PC

1. Click the bottom right corner of the desktop and click "Cast".

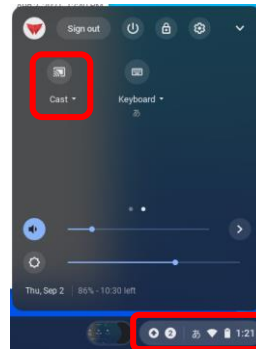

* If the cast destination display is not on the same network, the cast function will not be displayed.

2. Select the display name you want to connect to and the desktop will start casting.

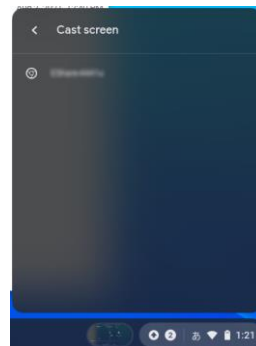

3. Click the status display at the bottom right of the desktop, and click "STOP" in the window to end the cast.

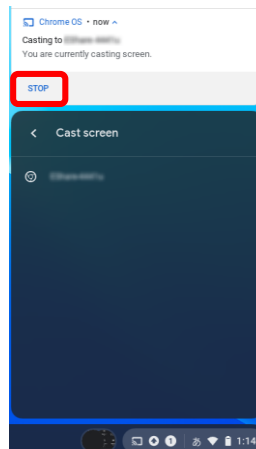

※ The BIG PAD screen cannot be displayed on Chrome OS devices.

Wireless Connection (macOS)

[macOS PC]

- Operate "EShare for SH" on the macOS PC

1. Click "Eshare for SH" 

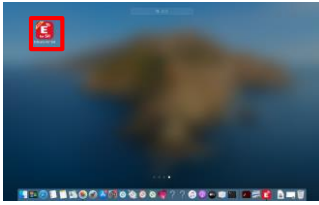

2. Select the BIG PAD you want to send and receive screen from the device list.

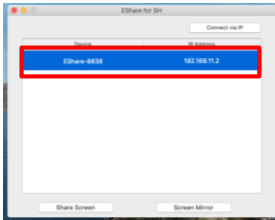

3. To display the screen of your PC on the BIG PAD, select "Share Screen".
Select "Stop Sharing" to stop screen sharing.

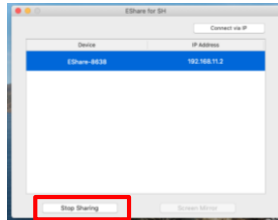
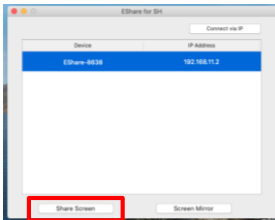

4. To display the BIG PAD screen on your PC, select "Screen Mirror".

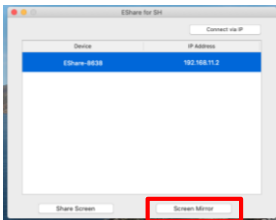

The BIG PAD screen will appear on your PC.

Click the red "●" in the upper left corner of the EShare window to stop screen mirroring.

- When the following message is displayed, please refer to page 4 to enable touchback.
If you do not want to use touchback, you do not need to enable it.

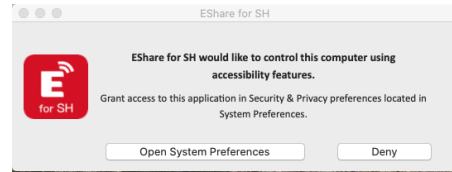

Wireless Connection (Android)

【Android device】

■ Operate “EShare for SH” on the Android device

1. Open Application list, tap “EShare for SH”



2. If a message appears asking for permission, follow the on-screen instructions to allow it.

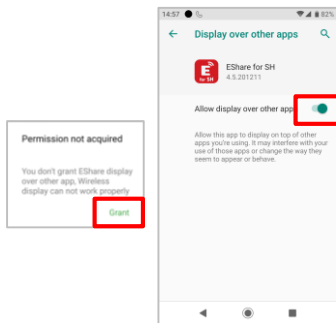
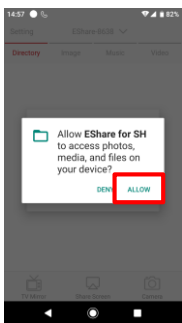

3. To display the screen of your device on the BIG PAD, select “TV Mirror”.



[received image]

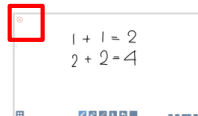

Click the “x” in the upper left corner to stop mirroring.

4. To display the BIG PAD screen on your device, select “Share Screen”.

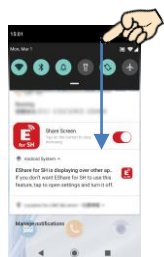

To stop screen sharing, slide the top of your Android device down to show the notification list, and select Share Screen(toggle switch).

5. If you want to use the wireless camera/microphone function, select “Camera”.

quit camera function

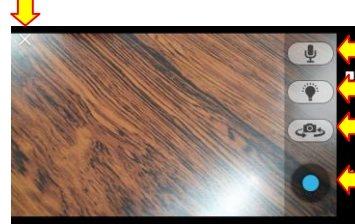

Press the shutter button to take a still image, which will remain on the BIG PAD screen. The captured still image will be saved as an image file on the device.

6. If you want to use the file sharing function, select the file you want to share from within the screen.

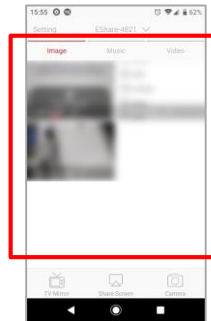

The remote control will appear on the screen during file sharing.



Image



Music

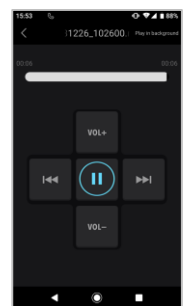

Video

Wireless Connection (iOS/iPadOS)

[iOS/iPadOS device]

■ Operate "EShare for SH" on the iOS/iPadOS device

1. Tap "EShare fo SH".

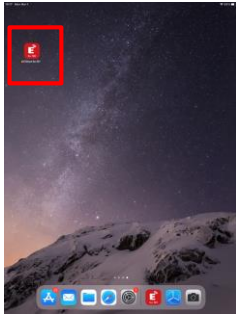

2. Select the BIG PAD you want to send and receive screen from the device list.

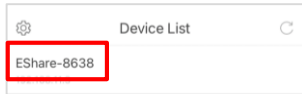

3. To display the screen of your device on the BIG PAD, select "Share Screen".



4. Select "Start Broadcast" to start sending after 3 counts. Press the home button to switch the application and display the content you want to send.

If there is a red line at the top of the screen, EShare is running.

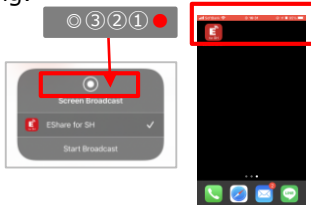

To stop the screen transmission, select the red line on the screen and select "OK" to stop the screen broadcast.

5. To display the BIG PAD screen on your device, select "TV Mirror".

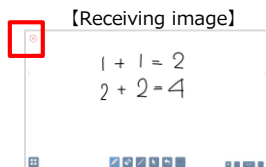

Click the "x" in the upper left corner to stop screen mirroring.

6. If you want to use the wireless camera/microphone function, select "Camera".



quit camera function

Press the shutter button to take a still image, which will remain on the BIG PAD screen. The captured still image will be saved as an image file on the device.

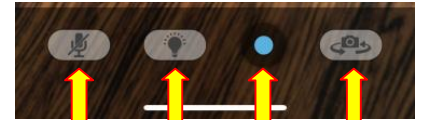

microphone
ON/OFF

mobile light
ON/OFF

shutter
button

switch between
in/out camera

7. If you want to use the file sharing function, select "Photo" or "Music/Video".

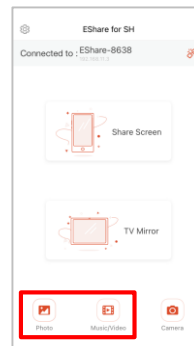

The remote control will appear on the screen during file sharing.



Photo

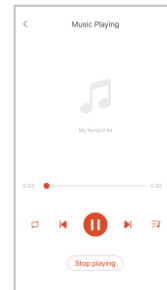

Music

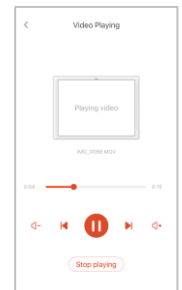

Video

Wireless Connection (Other functions)

■ Change the settings of EShareServer

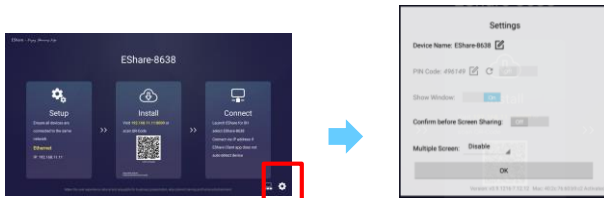

On the BIG PAD, touch  in the lower right corner of the EShareServer screen to display the setting screen.

- ☐ Change the device name of BIG PAD
You can change the device name of the BIG PAD.
- ☐ Setting PIN code
When the PIN code setting is turned ON, the PIN code must be entered when executing "Share Screen" or "Screen Mirror" on the device. This setting can be used to limit the devices that can be connected to the BIG PAD.
The PIN code can be set to any code.
- ☐ Setting PIN code display
When the PIN code display setting is turned on, the PIN code is displayed on the BIG PAD screen. If you do not want to display it, turn it OFF.
- ☐ Setting screen sharing permission confirmation
If you turn on "Confirm before Screen Sharing", when you send a screen from your device, a confirmation message will be displayed on the BIG PAD side, and the screen will be shared only if permission is allowed.
***Confirmation message is not displayed when "Screen Mirror" is executed on Windows/macOS.**



- ☐ Setting the display method for wireless connection of multiple devices (multi-screen)
When "Multi-Screen" is set to 2 or 4 Screens, the screen will be automatically divided and multiple receiving screens will be displayed simultaneously when screen transmissions are received from multiple devices up to the set number.
*** Only one connection can be made from Google Cast at a time. Up to 4 devices can be connected from the EShare Client.**

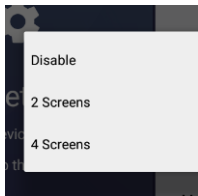

ex. 2 Screens







ex. 4 Screens



When you send the 5th screen, it will be as above.

When you touch the screen being displayed on the BIG PAD, the operation buttons will appear as shown below.

	Turns the audio on and off. In multi-screen display, when one of the screens is turned on, the remaining screens are automatically turned off.
	Switches between enabling and disabling touchback to the device. (Windows /macOS only)
	In multi-screen mode, temporarily switches the selected screen to full-screen mode.
	Disconnects screen sharing for the selected device.

■ Setting to display the same device's screen on multiple BIG PADs simultaneously (Display Group)

* Google Cast is not supported

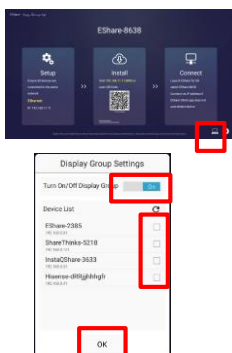

- Touch the bottom right corner of the EShareServer screen on the BIG PAD side  to display the setting screen.
- When you turn on the display group, the BIG PADs on the same network will be displayed in the list. touch OK, you can set the group setting with the checked device as the "Client" and the device that you set as the "Host".
- When you touch OK, you can set up a group with the checked device as the "Client" and the device that you set up as the "Host". For example, if you set up a group for each of two BIG PADs with the other as the Client device, when you send an image to one of the BIG PADs, the image will be displayed on the other BIG PAD.
- Multi-screen transmission is not possible for display groups.
- Audio can be played only from the Host. Touchback is also possible only on the Host.
- There is no limit to the number of groups that can be set, but actual operation depends on the network environment.

Wireless Connection (appendix)

■ Support for Wireless Sharing capability for OS updates

-Due to frequent updates in the supported client operating systems, SHARP cannot always guarantee a fully functional wireless sharing capability.

■ About "EShare for SH" app for Chrome OS and Android

-Starting with firmware ver. 1.60, the EShare application for Android is now the same as that for Chrome OS, "EShare for SH".

-With "EShare for SH," audio transmission during screen transmission is not possible. If you want to use audio transmission, please use Google Cast for screen transmission. Also, image/voice/video/camera transmission can be performed only with the Android device.

■ Notes on iOS/iPadOS

When using EShare for SH on an iOS/iPadOS device, the following dialog (error-1) may appear when screen sharing is stopped, but this indicates that screen sharing has been stopped and there is no problem.

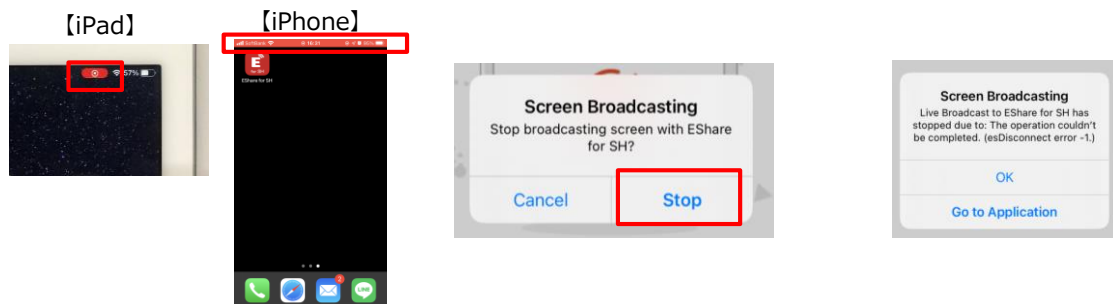

1. touch the red area

2. stop the screen sharing

3. A dialog box may appear.
In this case, select "OK".

The warning message displayed when starting screen sharing on iOS/iPadOS devices is difficult to read.
The contents are as follows.



Everything on your screen, including notifications, will be recorded. Enable Do Not Disturb to prevent unexpected notifications.

• If the screen goes off (sleep) during screen sharing on iOS/iPadOS devices, the screen sharing will also be terminated. If you don't want it to end automatically, please set the auto-lock to "None" or set a longer time.

■ Network requirement of EShare

• Please ensure that EShareServer and EShare Client are in the same subnet as each other.

TCP Ports: 56789, 25123, 8121 & 8000

UDP Ports: 48689, 25123

DNS: h1.ee-share.com

-Please enable Wi-Fi router broadcast function.

-To get a really reliable, robust user experience, it is strongly recommended to connect using 5GHZ Wi-Fi band.

【 Notes on the documents 】

Microsoft and Windows are registered trademarks or trademarks of Microsoft Corporation in the United States and other countries.

Android is a trademark of Google LLC.

Chrome OS is a trademark or registered trademarks of Google LLC.

Microsoft and Windows are either registered trademarks or trademarks of Microsoft Corporation in the United States and/or other countries.

SHARP

SHARP CORPORATION